

47 mm Stainless Steel Filtration Apparatus



Features

- Spin-lock connection (M381450) facilitates fast and stable installation without clamp.
- Stainless steel funnel offers excellent chemical resistance and can be fastly sterilized by flame.
- Built-in overflow protection to keep the filtrate from overflowing when waste bottle is full.

Specifications

Material	LF 30	LF 32
Funnel	PES	SS316
Support base	PC	SS316
Membrane support	PP	SS316
Waste bottle	PC	PC
Syringe filter	PTFE	-

Specifications

Funnel capacity	300 ml	100 ml
Flask capacity	1200 ml	1200 ml
Filter diameter	47 mm / 50 mm	47 mm / 50 mm
Effective filtration area	12.5 cm ²	9.6 cm ²
Hose barb	5/16 in. (8 mm)	5/16 inch (8 mm)
Syringe filter	25 mm, 0.2 µm	-

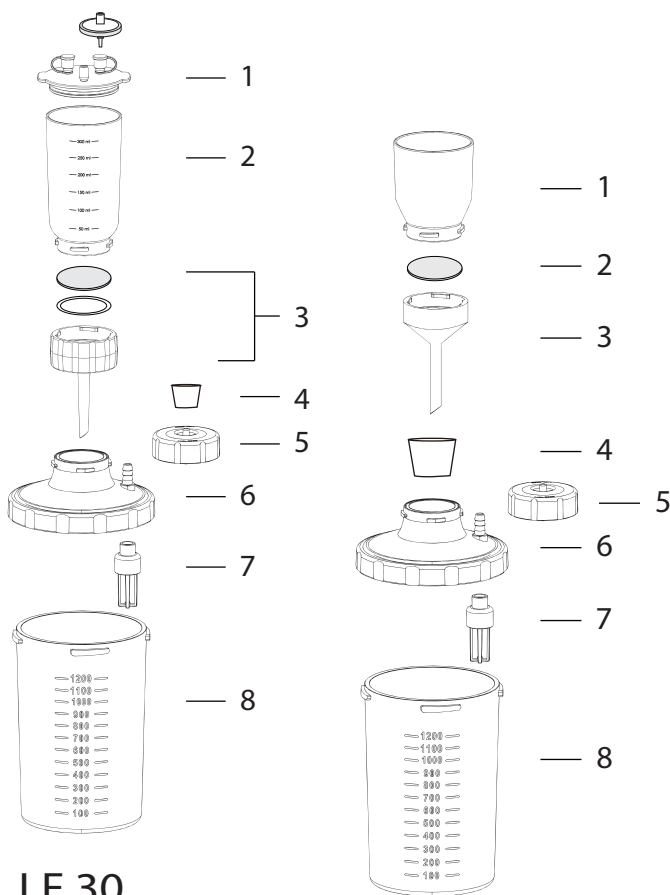

LF 30

LF 32

Ordering Information

LF 30, 47 mm Filtration Set	197010-30
LF 3, PES filter holder (300 ml) (1+2+3+4)	197000-01
1 PP lid kit	197000-36
2 PES funnel, 300 ml	197000-34
3 PC support base	197000-35
4 Silicone stopper (No.16)	167110-17
PC waste bottle with cover, 1200 ml (5+6+7+8)	197000-11-PC
5 Black PP cap	197000-40
6 PC cover	197000-32-PC
7 Overflow protection	197000-39
8 PC bottle, 1200 ml	197000-31-PC
LF 32, 47 mm Stainless Steel Filtration Set	197010-32
100 ml Stainless steel filter holder (1+2+3+4)	167103-10
1 Stainless steel funnel, 100 ml	167103-61
2 Stainless steel support screen	167100-31
3 Stainless steel support base	167103-60
4 Silicone stopper (No.16)	167110-17
PC waste bottle with cover, 1200 ml (5+6+7+8)	197000-11-PC
5 Black PP cap	197000-40
6 PC cover	197000-32-PC
7 Overflow protection	197000-39
8 PC bottle, 1200 ml	197000-31-PC